

RET GLOBAL

RIVET NUT MANUFACTURE

锐意进取,开拓创新
ENJOY PROCESS OF
CREATING SHARED VALUES.



WWW.RET-GLOBAL.COM

上海锐拓五金制品有限公司
SHANGHAI RIVET MANUFACTURE CO.,LTD

2014

公司简介

COMPANY PROFILE

上海锐拓五金制品有限公司成立于1994年，坐落于上海市金山工业园区，距离上海浦东机场近80公里，邻杭州湾跨海大桥。公司占地面积约30,000平方米，职工200余名，注册资本1280万人民币，固定资产约1亿人民币。

公司拥有一流的生产技术，先进的生产设备和雄厚的设计能力。拥有各类进口冷镦机40余台，攻丝机80余台，四条热处理流水线，光学筛选机和先进的自动包装机械。并具有独立的模具车间及综合实验室等。

公司拥有先进的质量管理体系和理念，2001年通过ISO9001:2008及TS16949国际质量体系认证。

上海锐拓五金制品有限公司主营紧固件系列中的螺母类产品：柳螺母，焊接螺母，以及各类汽车标准件。特别是我公司的柳螺母产品，广泛的使用在汽车，风能，铁道，电梯，配电柜，风机，空调，家具，建筑等机电及轻工产品的装备上。产品种类齐全，包括圆柱体、六角体、通孔、盲孔、（碳钢、不锈钢、铝和铜等不同材料）近1000款产品。上海锐拓计划发展成为中国大陆最大的柳螺母制造工厂。产品行销美国，日本，欧洲及中国市场。

上海锐拓五金制品有限公司热忱欢迎广大国内外朋友前来洽谈业务。我们始终不渝的秉承：“锐意进取、开拓创新、诚信务实、质量第一”的公司理念，在平等互利的基础上积极发展贸易，共展鸿业。



Established in 1994, Shanghai Rivet Manufacture Co., Ltd. located in Shanghai Jinshan Industrial park China. With Hangzhou Bay Bridge nearby, the company is about 80 kilometers to Shanghai Pudong International Airport. With 12 million RMB registered capital and 50 million RMB fixed assets, our company covers an area of 30,000 square meters and has more than 100 employees. We have top-ranking production technology, advanced equipment and great design ability.

We imported more than 40 cold-forging machines, 80 tapping machines, optic sorting machine and advanced automatic packaging machines from Taiwan. We also introduced four heat treatment flow lines and possess mould workshop and laboratory.

We have advanced quality control system and concept. We are ISO9001:2008 certified and also TS16949.

Now our company is majoring in nuts series: Rivet nuts, blind rivet, insert nuts, welded nuts, flange nuts and other kinds of auto standard parts. Our rivet nuts are widely used in automobile, railway, elevator, electric cabinet, ventilator, air-condition, furniture, construction and equipment in electric and light industry production. We have rivet nuts of more than 1000 kinds, including cylinder, hexagon, open end, close end, carbon steel, stainless steel, copper, aluminium etc. We plan to be the biggest rivet nut manufacturing factory in mainland China. Our products are well received domestically and also exported to America, South America, Asia and Europe.

Shanghai Rivet looks forward to cooperating with friends from home and abroad. We always carry out the policy of "Creativity, Quality, Credit and Surpass". Based on the foundation of equality and mutual benefit, we want to develop business with you and create a better future.



RIVET NUT

CREATIVITY QUALITY
SHANGHAI RIVET MANUFACTURE CO.,LTD

**锐意进取
开拓创新**



企业文化 **COMPANY CULTURE**

任何企业的成功与否，最终都取决于其对企业文化的积淀和扬弃，没有文化内蕴的企业必将无以流传久远，一个成功的企业必然拥有适合自己的企业文化，亦具有自己的文化内涵的精深企业理念，锐意进取，开拓创新，诚信务实，质量第一，期待时刻为客户提供，品质一流的产品和无微不至的服务！路就在脚下，只看你如何去走

The success of an enterprise is greatly determined by its Culture which should fit for itself. Any company without its own culture won't last long. RET, as a leading power in the fastener industry, knows clearly about this. Always doing better today than yesterday. This is the basic principle of RET. We pay great attention to team spirit. Human resources are the core power of our development. Forever pursuing higher quality and providing better service, this can make the company have sustainable development. That is why RET stands firm and erect in the market .



RET GLOBAL



生产设备 PRODUCTION EQUIPMENTS

要生产世界一流的产品，就必须配备世界一流的设备，锐拓先后从国外引进设备，使锐拓的产品迅速达到国际水准。

If an enterprise wants to produce first-class product, it has to be equipped with first-class machines. Ruituo has imported advanced equipment from foreign countries that produced in accordance with the international standards.



● 多工位冷墩机 Forming Machine



● 攻牙机 Tapping Machine



● 其他设备 Other machine

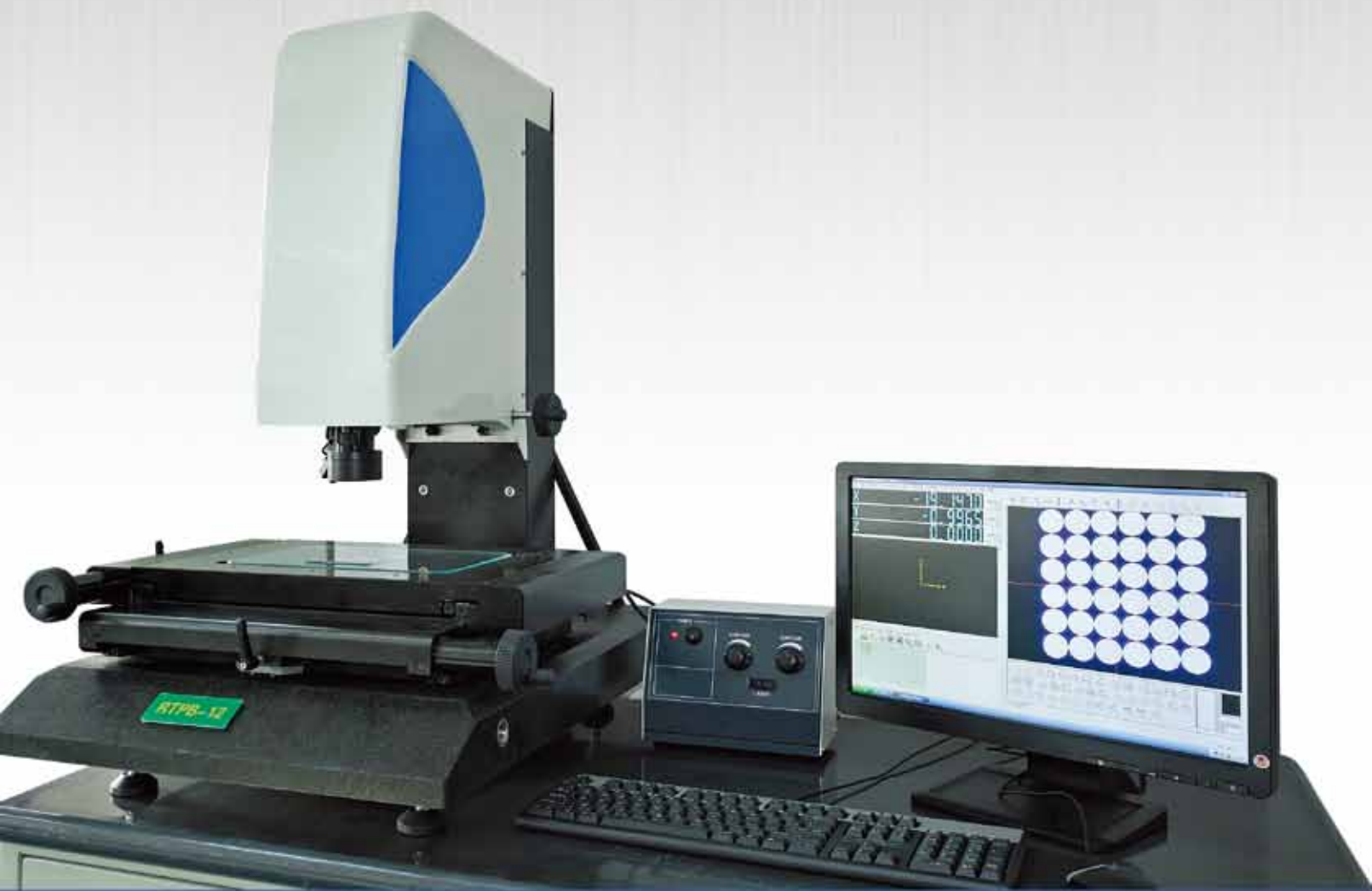

品质检测 QUALITY CONTROL

光学筛选机
Optical sorting machine



让技术检测产品的标准
Let technology inspect
the standard of products



让技术保证产品的质量
Let technology ensure
the quality of products

品质认证 
QUALITY CERTIFICATED



此为证书 IATF 0165485
 SGS CN10/20841 译本

下述组织

上海锐拓五金制品有限公司
 中国上海市
 金山工业区天工路 88 号

管理体系已通过审核，并被证明符合下述要求

ISO/TS 16949:2009
 版本 3

所涉及的活动范围覆盖
汽车用螺母的制造

不包括：7.3 产品设计
 三年认证有效期自 2013-06-27 至 2016-06-26
 并须经过符合要求的监督审核保持有效
 版本号 02 当前版本更新于 2013-06-27
 持续认证需在 2016-04-28 之前执行
 初始注册日期 2010-07-02



此为证书 CN10/20716 译本

下述组织

五金制品有限公司
 中国上海市
 金山工业区天工路 88 号

体系已通过审核，并被证明符合下述要求

ISO 9001:2008

所涉及的活动范围覆盖
螺母的制造

的适用范围，可向组织咨询获得
 2013-06-27 至 2016-06-27
 的监督审核保持有效
 2016-04-28 之前执行
 注册日期 2010-07-02



Signature

Veto Power Authority

House, Johns Lane, Twickenham, Surrey TW20 2EX, UK
 Tel: 0121 521 5771, Fax: 0121 522 4150
 E-mail: Neil.Hall@sgs.com

SGS TS-9 0512
 第 1 页 共 1 页

实力见证 
STRENGTH CAN TALK



经过多年的不断努力, 我已经建立了一套完整的企业内部管理体系和质量控制体系, 并通过和获得了多种审核和各项专利认证。

After years of efforts, our company has established a complete system of internal management and quality control system, and through a variety of domestic and international auditing and certification.



产品应用

PRODUCT APPLICATION

上海锐拓五金制品有限公司的产品广泛应用于国内众多企业及国家重点建设工程,配电柜、风机、汽车、铁道、电梯、空调、家具、建筑等机电及轻工产品的装配上。并行销美国、日本、欧洲、东南亚等国家和地区。

Our fastening and assembly technology are used in a diverse range of applications:

- 1.Cars and motorcycles,bumpers,safety belts, airbage etc.
- 2.Commercial vehicles,trailers,fire gngines electrical and electronic products,safety cabinets.
- 3.Food processing industry,ovens,extraction hoods,fast food counter etc.
- 4.Heating and ventilation plant,air conditioning units and heating boilers etc.
- 5.Office furniture,cash registers,chairs,desks,photocopiers etc.
- 6.Building and civil engineering,street furniture,conservatories in Leisure areas,climbing walls yachts,swimming pools etc.



产品目录

PRODUCT CONTENTS

P14



FH-RB

FH-RBC

P20



FH-FHB

FH-FHBC

P15



RH-RB

RH-RBC

P21



RHH-FHB

RHH-FHBC

P16



FH-KB

FH-KBC

P22



RHH-IHB

FH-IHB

P17



RH-KB

RH-KBC

P23



RH-RB-UK

RH-KB-UK

P18



CH-RB

CH-KB

P24



RHH-IHB-UK

FH-IHB-UK

P19



FH-SHB

FH-SHBC

P25
P26



FH-KB-US

SFH-KB-US

P27



FH-RB/SS

FH-RBC/SS

P33



FH-IHB/SS

FH-IHBC/SS

P28



FH-KB/SS

FH-KBC/SS

P34



FH-RB/AL

RH-RB/AL

P29



RH-RB/SS

RH-RBC/SS

P35



FH-KB/AL

RH-KB/AL

P30



RH-KB/SS

RH-KBC/SS

P36



FH-SQB

FH-SLB

P31



CH-RB/SS

CH-KB/SS

P37
P38



其它

其它

P32



RHH-IHB/SS

RHH-IHBC/SS

P39
P40



压铆螺母
技术参数

其它

其它

铆螺母技术条件

TECHNICAL DATA SHEET

(标准STANDARD BY :GB/T17880.6-1999)

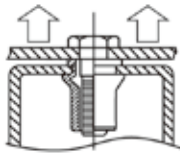

Axial proof load

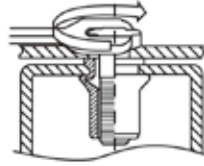

Broken torque

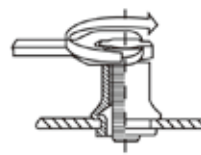

Torque to turn

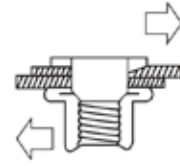

Shearing strength

TABLE 1: AXIAL PROOF LOAD FOR THREAD (保证载荷)

Unit:N

铆螺母 Rivet nut	机械性能 Mechanical char	螺纹规格 Thread size							
		M3	M4	M5	M6	M8	M10	M12	
平头, (小)沉头, 圆柱, 六角 Round and Hex, Flat and (Reduced) countersunk head	保证载荷 Proof load	不锈钢, 碳钢 steel/stainless steel	3900	6800	11500	16500	25000	32000	34000
	铝 Aluminum	1900	4000	6500	7800	12300	17500	---	

TABLE 2: BROKEN TORQUE (破坏扭矩)

Unit:N.m

螺纹规格 Thread size	M3	M4	M5	M6	M8	M10	M12
Steel/Inox Flat head, round and hex	2	5	8.5	15	26	50	80
Steel/ Inox Countersunk head, round and hex	1	4	8	15	26	45	70
Steel/Inox Reduced head, round and hex	1	3	6	11	20	32	50
Alu Flat and reduced (counter) head round body	0.7	2.5	5	8	20	25	---

TABLE 3: TURNING TORQUE FOR CLAMPING FORCE (转动扭矩)

Unit:N.m

螺纹规格 Thread size	M3	M4	M5	M6	M8	M10	M12
Steel/Inox Flat head, round body	0.5	1	2	4.5	5.5	11	30
Steel/Inox (Reduced)counter head round	0.4	0.8	1.5	3.5	4.5	8.5	24
Aluminum Flat head, round body	0.25	0.9	1.5	3.5	5	6.5	21
Aluminum (Reduced) counter, round body	0.2	0.7	1.2	2.5	4	5	16

TABLE 4: SHEARING STRENGTH (剪切力)

Unit:N

铆螺母 Rivet nut	机械性能 Mechanical char	螺纹规格 Thread size							
		M3	M4	M5	M6	M8	M10	M12	
Round and Hex, Flat and (Reduced) countersunk head	剪切力 Shearing	不锈钢, 碳钢 steel/stainless steel	900	1500	2000	3000	4400	5000	6500
		铝 Aluminum	600	1000	1200	2000	2400	3800	---

材质: 1. 碳钢Steel for C1008 2. 不锈钢 Stainless steel for ANSI304 3. 铝Aluminum for Almg2.5

以上所以技术资料仅供参考。以我们的实际检测报告为准。

ALL THESE DATA ARE JUST FOR YOUR REFERENCE.THE EXACT DATA PLEASE FOLLOW OUR PHYSICAL TESTS.

产品展示

PRODUCT INTRODUCE

FH-RB Flat Head Round Body Plain 平头菊花

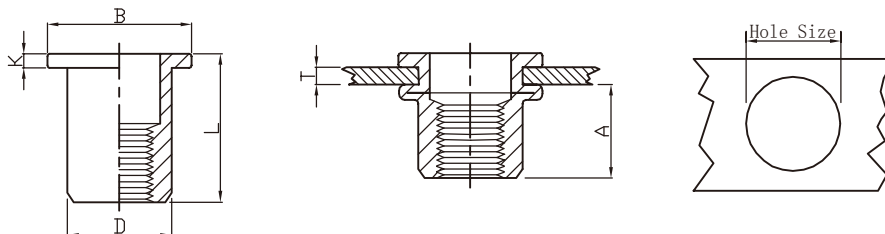

UNIT(单位): mm

螺纹 Thread	编号 P/N	T(GRIP RANGE) Min Max	A Rer	Hole Size $+0.1$ 0	D $+0.07$ -0.1	B	K	L
M3	FH-RB-0315	0.5-1.5	4.7	5.0	4.9	7.2	0.8	8.5
	FH-RB-0325	1.5-2.5						9.5
M4	FH-RB-0420	0.5-2.0	6.0	6.0	5.9	8.5	0.8	10.5
	FH-RB-0435	2.0-3.5						12.0
M5	FH-RB-0525	0.5-2.5	7.5	7.0	6.9	10.0	1.0	13.0
	FH-RB-0550	2.5-5.0	8.5					17.0
M6	FH-RB-0630	0.5-3.0	9.2	9.0	8.9	12.3	1.3	15.5
	FH-RB-0655	3.0-5.5						18.0
M8	FH-RB-0835	0.5-3.5	11.5	11.0	10.9	15.0	1.5	18.5
	FH-RB-0860	3.5-6.0						21.0
M10	FH-RB-1025	0.5-2.5	11.5	13.0	12.9	16.3	1.5	17.0
M10	FH-RB-1040	2.5-4.0	12.5	13.0	12.9	17.0	1.6	21.0
	FH-RB-1060	4.0-6.0						24.0
M10	FH-RB-1035(12H)	1.0-3.5	11.0	12.0	11.9	16.0	1.6	19.0
M12	FH-RB-1240	1.0-4.0	13.5	15.0	14.9	18.0	1.7	22.0
	FH-RB-1265	4.0-6.5						25.0
M12	FH-RB-1240(16H)	1.0-4.0	16.0	16.0	15.9	22.0	2.0	25.0

※可以按客人要求生产M14,M16钢螺母。 M14, M16 Size is available.

FH-RBC Flat Head Round Body Plain Close End 平头菊花(盲孔)

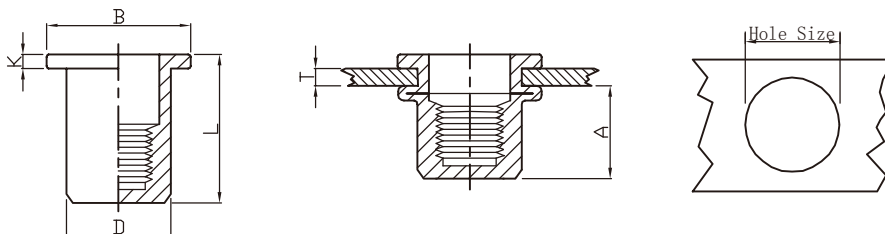

UNIT(单位): mm

螺纹 Thread	编号 P/N	T(GRIP RANGE) Min Max	A Rer	Hole Size $+0.1$ 0	D $+0.07$ -0.1	B	K	L
M3	FH-RBC-0315	0.5-1.5	10.0	5.0	4.9	7.2	0.8	13.3
M4	FH-RBC-0420	0.5-2.0	11.3	6.0	5.9	9.0	0.8	16.0
	FH-RBC-0440	2.0-4.0						18.0
M5	FH-RBC-0525	0.5-2.5	11.5	7.0	6.9	10.0	1.0	17.0
	FH-RBC-0550	2.5-5.0						19.0
M6	FH-RBC-0630	0.5-3.0	12.7	9.0	8.9	12.3	1.3	19.2
	FH-RBC-0650	3.0-5.5						21.0
M8	FH-RBC-0830	0.5-3.0	14.8	11.0	10.9	15.0	1.5	21.5
	FH-RBC-0855	3.0-5.5						24.0
M10	FH-RBC-1040	1.0-4.0	19.2	13.0	12.9	17.0	1.6	27.0

产品展示

PRODUCT INTRODUCE

RH-RB Reduce Head Round Body Plain 小沉头菊花

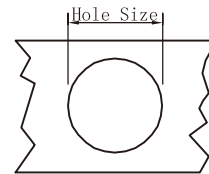
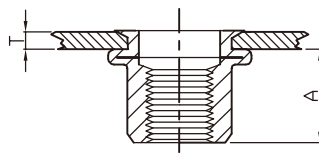
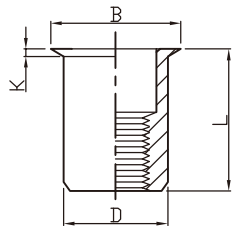

UNIT(单位): mm

螺纹 Thread	编号 P/N	T(GRIP RANGE)		A Rer	Hole Size $+0.1$ 0	D $+0.07$ -0.1	B	K	L
		Min	Max						
M3	RH-RB-0315	0.5	1.5	6.2	5.0	4.9	6.0	0.5	9.0
M4	RH-RB-0420	0.5	2.0	6.5	6.0	5.9	7.0	0.5	10.5
	RH-RB-0440	2.0	4.0						13.0
M5	RH-RB-0520	0.5	2.0	7.0	7.0	6.9	8.0	0.5	11.5
	RH-RB-0540	2.0	4.0						13.0
M6	RH-RB-0625	0.5	2.5	8.5	9.0	8.9	10.5	0.6	14.0
	RH-RB-0650	2.5	5.0					0.6	17.0
M8	RH-RB-0830	0.5	3.0	10.0	11.0	10.9	12.0	0.65	16.5
	RH-RB-0850	3.0	5.0						18.5
M10	RH-RB-1030	0.5	3.0	13.0	13.0	12.9	14.1	0.7	17.7
	RH-RB-1055	3.0	5.5						21.0
M10	RH-RB-1030(12H)	0.5	3.0	12.5	12.0	11.9	13.0	0.7	18.0

RH-RBC Reduce Head Round Body Plain Close End 小沉头圆柱(盲孔)

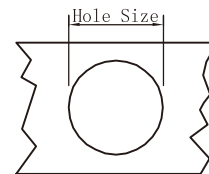
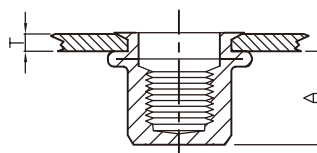
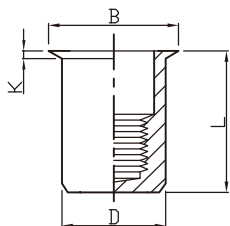

UNIT(单位): mm

螺纹 Thread	编号 P/N	T(GRIP RANGE)		A Rer	Hole Size $+0.1$ 0	D $+0.07$ -0.1	B	K	L
		Min	Max						
M4	RH-RBC-0420	0.5	2.0	11.0	6.0	5.9	7.0	0.5	15.0
	RH-RBC-0435	2.0	3.5						16.0
M5	RH-RBC-0520	0.5	2.0	12.5	7.0	6.9	8.0	0.5	16.5
	RH-RBC-0535	2.0	3.5						17.5
M6	RH-RBC-0625	0.5	2.5	15.5	9.0	8.9	10.0	0.6	20.5
	RH-RBC-0640	2.5	4.0						22.0
M8	RH-RBC-0830	0.5	3.0	17.0	11.0	10.9	12.0	0.65	23.0
	RH-RBC-0845	2.5	4.5						24.5
M10	RH-RBC-1030	1.0	3.0	18.2	13.0	12.9	14.1	0.7	24.5
	RH-RBC-1050	3.0	5.0						26.0

FH-KB Flat Head Knurled Body 平头菊花条纹

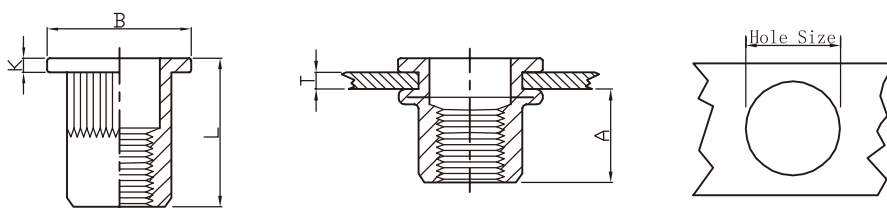

UNIT(单位): mm

螺纹 Thread	编号 P/N	T(GRIP RANGE)		A Rer	Hole Size $+0.1$ 0	D $+0.07$ -0.1	B	K	L
		Min	Max						
M3	FH-KB-0315	0.5	1.5	6.0	5.0	4.9	8.0	0.8	10.0
M4	FH-KB-0420	0.5	2.0	6.0	6.0	5.9	9.0	0.8	10.5
	FH-KB-0435	2.0	3.5						
M5	FH-KB-0525	0.5	2.5	7.5	7.0	6.9	10.0	1.0	13.0
	FH-KB-0550	2.5	5.0						
M6	FH-KB-0630	0.5	3.0	9.2	9.0	8.9	12.30 (*13.0)	1.3	15.5
	FH-KB-0655	3.0	5.5						
M8	FH-KB-0835	1.0	3.5	11.5	11.0	10.9	14.5(*16.0)	1.5	18.5
	FH-KB-0860	3.5	6.0						
M10	FH-KB-1040	1.0	4.0	13.5	13.0	12.9	17.0(*19.0)	1.7	21.5
	FH-KB-1065	4.0	6.5						
M12	FH-KB-1240	1.0	4.0	13.5	15.0	14.9	18.0	1.7	22.0
	FH-KB-1265	4.0	6.5						
M10	FH-KB-1035(12H)	1.0	3.5	11.0	12.0	11.9	16.0	1.6	19.0
M12	FH-KB-1240(16H)	1.0	4.0	15.0	16.0	15.9	22.0	2.0	25.0
	FH-KB-1260(16H)	3.5	6.0						

※部分为可代替尺寸, 客户需要请另做说明 Part are different series, if customer need this size, please mark.
 ※这个系列的产品包含带菊花和不带菊花系列 All this part included serration or without serration under the flange.

FH-KBC Flat Head Knurled Body Close End 平头竖条纹(盲孔)

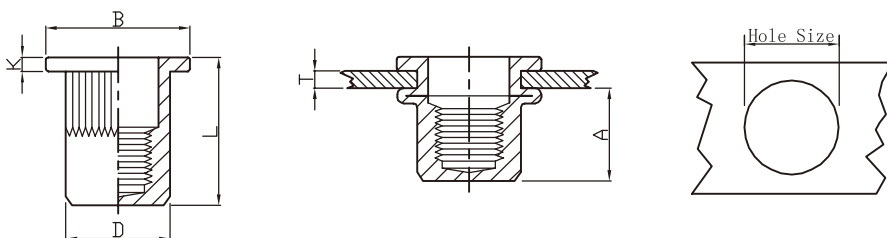

UNIT(单位): mm

螺纹 Thread	编号 P/N	T(GRIP RANGE)		A Rer	Hole Size $+0.1$ 0	D $+0.07$ -0.1	B	K	L
		Min	Max						
M4	FH-KBC-0420	0.5	2.0	11.3	6.0	5.9	9.0	0.8	16.0
	FH-KBC-0440	2.0	4.0						
M5	FH-KBC-0530	0.5	3.0	11.5	7.0	6.9	10.0	1.0	17.0
	FH-KBC-0550	2.5	5.0						
M6	FH-KBC-0630	0.5	3.0	12.7	9.0	8.9	12.3	1.3	19.2
	FH-KBC-0650	3.0	5.0						
M8	FH-KBC-0830	0.5	3.0	14.8	11.0	10.9	15.0	1.5	21.5
	FH-KBC-0855	3.0	5.5						
M10	FH-KBC-1040	1.0	4.0	19.2	13.0	12.9	17.0	1.6	27.0

产品展示

PRODUCT INTRODUCE

RH-KB Reduce Head Knurled Body 小沉头竖条纹

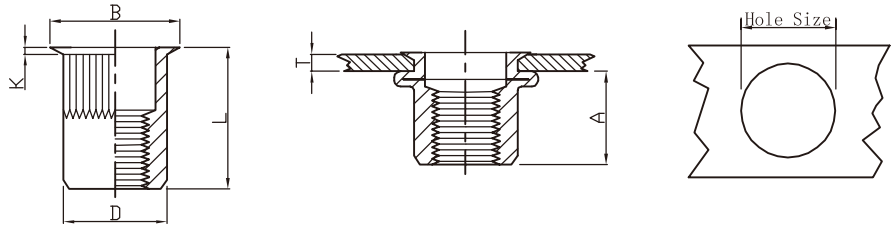

UNIT(单位): mm

螺纹 Thread	编号 P/N	T(GRIP RANGE) Min Max	A Rer	Hole Size $+0.1$ 0	D $+0.07$ -0.1	B	K	L
M3	RH-KB-0320	0.5-2.0	6.2	5.0	4.9	6.0	0.5	9.0
M4	RH-KB-0420	0.5-2.0	7.0	6.0	5.9	7.0	0.5	11.2
	RH-KB-0440	2.0-4.0						13.0
M5	RH-KB-0520	0.5-2.0	7.0	7.0	6.9	8.0	0.5	11.5
	RH-KB-0540	2.0-4.0						13.0
M6	RH-KB-0625	0.5-2.5	8.5	9.0	8.9	10.0	0.6	14.0
	RH-KB-0650	2.5-5.0						16.0
M8	RH-KB-0830	0.5-3.0	10.0	11.0	10.9	12.0	0.65	16.5
	RH-KB-0850	3.0-5.0						18.5
M10	RH-KB-1035	1.0-3.5	12.5	13.0	12.9	14.0	0.7	19.5
	RH-KB-1060	3.5-6.0						22.0
M10	RH-KB-1035(12H)	1.0-3.5	12.5	12.0	11.9	13.0	0.7	19.5
M12	RH-KB-1240	1.0-4.0	16.2	16.0	15.9	17.6	0.75	24.2

RH-KBC Reduce Head Knurled Body Close End 小沉头竖条纹

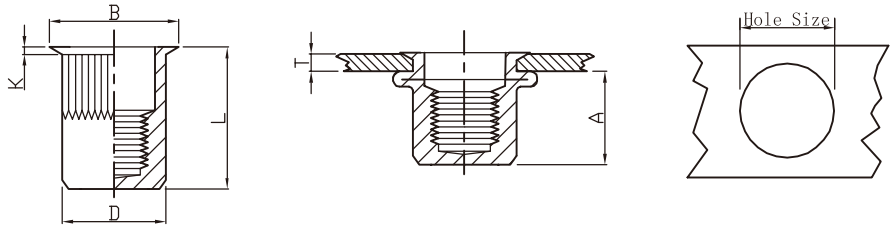

UNIT(单位): mm

螺纹 Thread	编号 P/N	T(GRIP RANGE) Min Max	A Rer	Hole Size $+0.1$ 0	D $+0.07$ -0.1	B	K	L
M4	RH-KBC-0420	0.5-2.0	11.0	6.0	5.9	7.0	0.5	15.0
	RH-KBC-0435	2.0-3.5						16.5
M5	RH-KBC-0520	0.5-2.0	12.5	7.0	6.9	8.0	0.5	16.5
	RH-KBC-0535	2.0-3.5						18.0
M6	RH-KBC-0630	0.5-3.0	15.5	9.0	8.9	10.0	0.6	20.5
	RH-KBC-0645	3.0-4.5						22.0
M8	RH-KBC-0830	0.5-3.0	17.0	11.0	10.9	12.0	0.65	23.0
	RH-KBC-0845	3.0-4.5						24.5
M10	RH-KBC-1030	1.0-3.0	18.2	13.0	12.9	14.0	0.7	24.5
	RH-KBC-1050	3.0-5.0						26.0

CH-RB Countersunk Head Round Body Plain 大沉头菊花

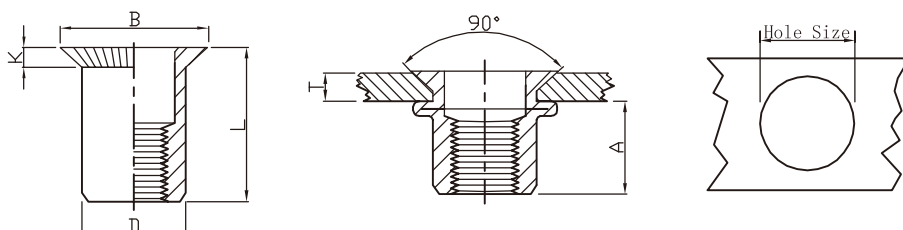

UNIT(单位): mm

螺纹 Thread	编号 P/N	T(GRIP RANGE)		A Rer	Hole Size $+0.1$ 0	D $+0.07$ -0.1	B	K	L
		Min	Max						
M4	CH-RB-0430	1.5	3.0	6.5	6.0	5.9	9.0	1.5	12.0
M5	CH-RB-0535	1.5	3.5	7.5	7.0	6.9	10.0	1.5	13.0
M6	CH-RB-0640	1.5	4.0	9.0	9.0	8.9	12.0	1.5	15.5
M8	CH-RB-0845	2.0	4.5	11.0	11.0	10.9	14.0	1.5	18.5
M10	CH-RB-1050	2.0	5.0	13.0	13.0	12.9	16.0	1.5	21.0

CH-KB Countersunk Head Knurled Body 大沉头菊花竖条纹

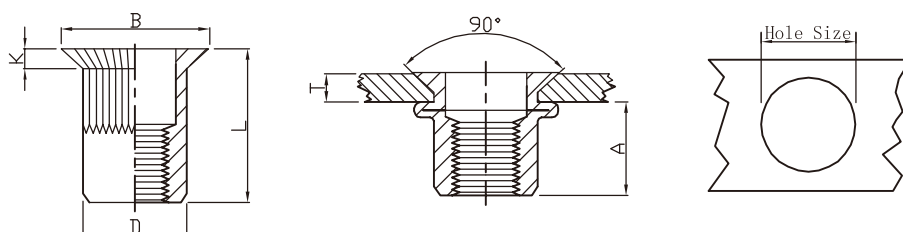

UNIT(单位): mm

螺纹 Thread	编号 P/N	T(GRIP RANGE)		A Rer	Hole Size $+0.1$ 0	D $+0.07$ -0.1	B	K	L
		Min	Max						
M4	CH-KB-0430	1.5	3.0	6.5	6.0	5.9	9.0	1.5	12.0
M5	CH-KB-0535	1.5	3.5	7.5	7.0	6.9	10.0	1.5	13.0
M6	CH-KB-0640	1.5	4.0	9.0	9.0	8.9	12.0	1.5	15.5
M8	CH-KB-0845	2.0	4.5	11.0	11.0	10.9	14.0	1.5	18.5
M10	CH-KB-1050	2.0	5.0	13.0	13.0	12.9	16.0	1.5	21.0
M12	CH-KB-1250(16H)	2.0	5.0	16.5	16.0	15.9	19.0	1.5	24.0

产品展示

PRODUCT INTRODUCE

FH-SHB Flat Head Semi-Hex Body 平头半六角

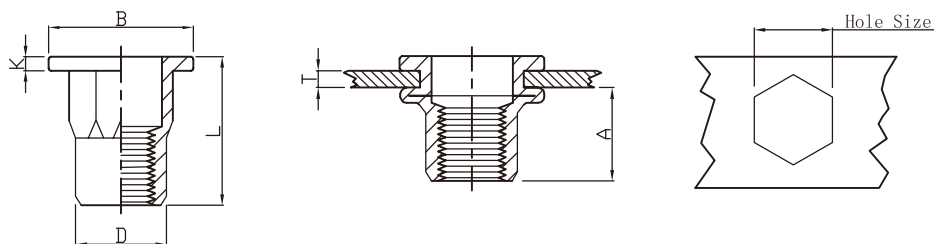

UNIT(单位): mm

螺纹 Thread	编号 P/N	T(GRIP RANGE)		A Rer	Hole Size $+0.1$ 0	D $+0.07$ -0.1	B	K	L
		Min	Max						
M4	FH-SHB-0420	0.5	2.0	6.5	6.0	5.9	9.0	0.8	11.0
M5	FH-SHB-0525	0.5	2.5	8.0	7.0	6.9	10.0	1.0	13.0
M6	FH-SHB-0630	0.5	3.0	8.5	9.0	8.9	12.7	1.35	15.0
M8	FH-SHB-0835	1.0	3.5	10.5	11.0	10.9	16.0	1.5	18.0
M10	FH-SHB-1035	1.0	3.5	12.5	13.0	12.9	18.0	1.7	21.0
M12	FH-SHB-1240	1.0	4.0	14.0	15.0	14.9	20.0	1.7	23.0
M10	FH-SHB-1035(12H)	1.0	3.5	11.0	12.0	11.9	17.0	1.6	19.0
M12	FH-SHB-1250(16H)	2.0	5.0	16.5	16.0	15.9	23.0	2.2	27.5

FH-SHBC Flat Head Semi-Hex Body Close End 平头半六角(盲孔)

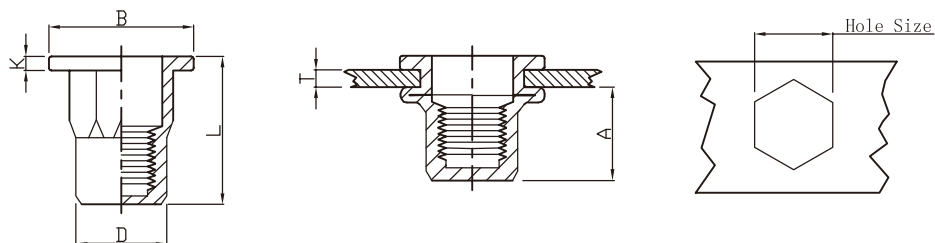

UNIT(单位): mm

螺纹 Thread	编号 P/N	T(GRIP RANGE)		A Rer	Hole Size $+0.1$ 0	D $+0.07$ -0.1	B	K	L
		Min	Max						
M4	FH-SHBC-0420	0.5	2.0	11.0	6.0	5.9	9.0	0.8	15.0
M5	FH-SHBC-0525	0.5	2.5	13.5	7.0	6.9	10.0	1.0	18.0
M6	FH-SHBC-0630	0.5	3.0	17.0	9.0	8.9	12.7	1.3	23.0
M8	FH-SHBC-0835	1.0	3.5	19.0	11.0	10.9	16.0	1.5	26.0
M10	FH-SHBC-1040	1.0	4.0	25.0	13.0	12.9	19.0	1.7	33.0

FH-FHB Flat Head Full Hex Body 平头全六角

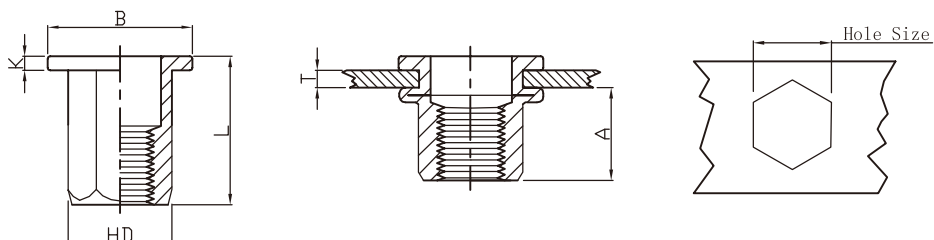

UNIT(单位): mm

螺纹 Thread	编号 P/N	T(GRIP RANGE)		A Rer	Hole Size $+0.1$ 0	HD $+0.07$ -0.1	B	K	L
		Min	Max						
M4	FH-FHB-0420	0.5	2.0	6.5	6.0	5.9	9.0	0.8	11.0
M5	FH-FHB-0525	0.5	2.5	8.0	7.0	6.9	10.0	1.0	14.0
M6	FH-FHB-0630	0.5	3.0	8.5	9.0	8.9	12.7(*13.0)	1.35	15.0(*16.0)
M8	FH-FHB-0835	1.0	3.5	10.5	11.0	10.9	16.0	1.5	18.0
M10	FH-FHB-1035	1.0	3.5	12.5	13.0	12.9	18.0(*19.0)	1.7	21.0(*23.0)
M12	FH-FHB-1240	1.0	4.0	14.0	15.0	14.9	20.0	1.7	23.0
M10	FH-FHB-1035(12H)	1.0	3.5	13.5	12.0	11.9	18.0	1.7	21.0
M12	FH-FHB-1250(16H)	2.0	5.0	16.5	16.0	15.9	23.0	2.0	27.0

※部分为可代替尺寸，客户需要请另做说明

※Part are different series, if customer need this size, please mark.

FH-FHBC Flat Head Full Hex Body Close End 平头全六角(盲孔)

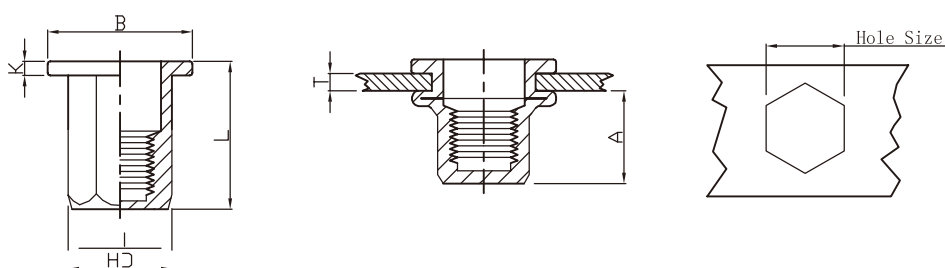

UNIT(单位): mm

螺纹 Thread	编号 P/N	T(GRIP RANGE)		A Rer	Hole Size $+0.1$ 0	HD $+0.07$ -0.1	B	K	L
		Min	Max						
M4	FH-FHBC-0420	0.5	2.0	11.0	6.0	5.9	9.0	1.0	15.0
M5	FH-FHBC-0525	0.5	2.5	13.5	7.0	6.9	10.0	1.0	18.0
M6	FH-FHBC-0630	0.5	3.0	17.0	9.0	8.9	12.7	1.5	23.0
M8	FH-FHBC-0835	1.0	3.5	19.0	11.0	10.9	16.0	1.5	26.0
M10	FH-FHBC-1040	1.0	4.0	25.0	13.0	12.9	19.0	2.0	33.0

产品展示

PRODUCT INTRODUCE

RHH-FHB Reduce Hex Head Full-Hex Body 小沉头全六角

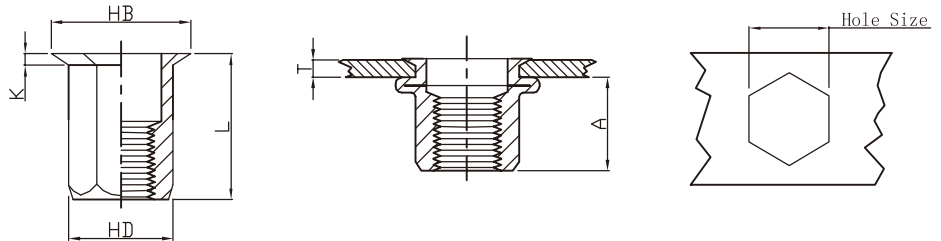

UNIT(单位): mm

螺纹 Thread	编号 P/N	T(GRIP RANGE) Min Max	A Rer	Hole Size $+0.1$ 0	HD $+0.07$ -0.1	HB	K	L
M4	RHH-FHB-0425	0.5-2.5	6.7	6.0	5.9	7.0	0.5	11.0
	RHH-FHB-0450	2.5-5.0						13.5
M5	RHH-FHB-0530	0.5-3.0	9.0	7.0	6.9	8.0	0.5	14.5
	RHH-FHB-0550	3.0-5.0						16.0
M6	RHH-FHB-0635	1.0-3.5	10.0	9.0	8.9	10.0	0.6	16.0
	RHH-FHB-0660	3.5-6.0						18.0
M8	RHH-FHB-0840	1.0-4.0	11.5	11.0	10.9	12.0	0.65	18.0
	RHH-FHB-0860	4.0-6.0						20.0
M10	RHH-FHB-1035	1.0-3.5	12.5	13.0	12.9	14.5	0.75	19.0
	RHH-FHB-1060	3.5-6.0						23.5

※我们同时生产 M12. M12 is available

RHH-FHBC Reduce Hex Head Full-Hex Body Close End 小沉头全六角(盲孔)

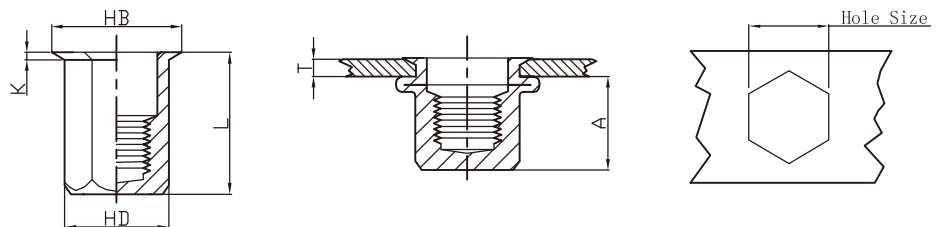

UNIT(单位): mm

螺纹 Thread	编号 P/N	T(GRIP RANGE) Min Max	A Rer	Hole Size $+0.1$ 0	HD $+0.07$ -0.1	HB	K	L
M4	RHH-FHBC-0425	0.5-2.5	12.3	6.0	5.9	7.0	0.5	16.0
M5	RHH-FHBC-0530	0.5-3.0	15.2	7.0	6.9	8.0	0.5	20.0
M6	RHH-FHBC-0635	0.5-3.5	14.5	9.0	8.9	10.0	0.6	20.5
M8	RHH-FHBC-0840	1.0-4.0	17.0	11.0	10.9	12.0	0.65	23.0
M10	RHH-FHBC-1045	1.0-4.5	20.0	13.0	12.9	14.5	0.75	28.5

RHH-IHB Reduce Hex Head Inner-Hex Body 小沉头内外六角

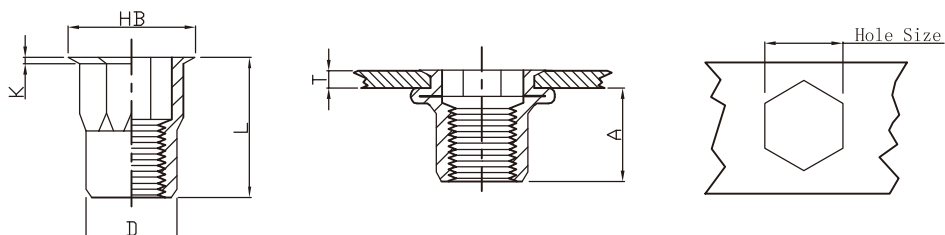

UNIT(单位): mm

螺纹 Thread	编号 P/N	T(GRIP RANGE)		A Rer	Hole Size $+0.1$ 0	D $+0.07$ -0.1	HB	K	L
		Min	Max						
M4	RHH-IHB-0420	0.5	2.0	8.3	6.0	5.9	7.0	0.5	12.0
M5	RHH-IHB-0525	0.5	2.5	8.7	7.0	6.9	8.0	0.5	13.0
M6	RHH-IHB-0635	1.0	3.5	10.5	9.0	8.9	10.0	0.6	16.0
M8	RHH-IHB-0835	1.0	3.5	11.3	11.0	10.9	12.0	0.65	17.5
M10	RHH-IHB-1040	1.0	4.0	12.8	13.0	12.9	14.5	0.75	21.0

FH-IHB Flat Head Inner-Hex Body 平头内外六角

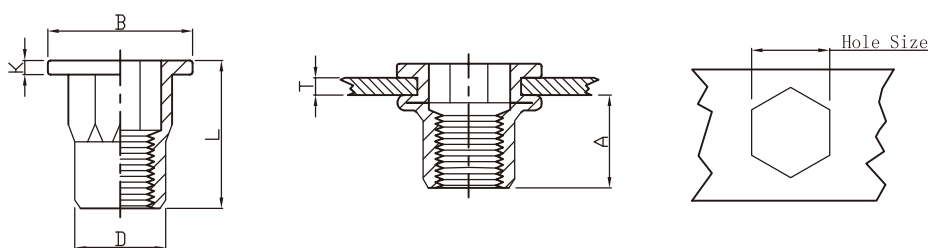

UNIT(单位): mm

螺纹 Thread	编号 P/N	T(GRIP RANGE)		A Rer	Hole Size $+0.1$ 0	D $+0.07$ -0.1	B	K	L
		Min	Max						
M4	FH-IHB-0420	0.5	2.0	7.0	6.0	5.9	9.0	0.8	11.0
M5	FH-IHB-0525	0.5	2.5	7.5	7.0	6.9	10.0	1.0	12.0
M6	FH-IHB-0630	0.5	3.0	9.2	9.0	8.9	12.7	1.3	15.5
M8	FH-IHB-0835	1.0	3.5	11.2	11.0	10.9	16.0	1.5	18.0
M10	FH-IHB-1035	1.0	3.5	12.8	13.0	12.9	18.0	1.7	21.0

产品展示

PRODUCT INTRODUCE

RH-RB-UK Reduce Head Round Body Plain-UK 小沉菊花(英标)

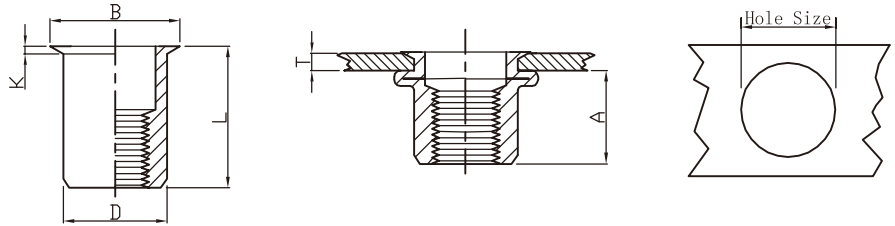

UNIT(单位): mm

螺纹 Thread	编号 P/N	T(GRIP RANGE)		A Rer	Hole Size $\begin{matrix} +0.1 \\ 0 \end{matrix}$	D $\pm 0.05 \begin{matrix} * \\ +0.07 \\ -0.1 \end{matrix}$	B	K	L
		Min	Max						
M3	RH-RB-UK-0315	0.5	1.5	5.5	4.8	4.65	5.4	0.4	9.0
M4	RH-RB-UK-0420	0.5	2.0	6.5	6.4	6.25	7.0	0.5	10.5
M5	RH-RB-UK-0525	0.5	2.5	7.5	7.2	7.05	7.8	0.5	12.0
M6	RH-RB-UK-0630	1.0	3.0	9.2	9.6	9.45	10.3	0.6	15.0
M8	RH-RB-UK-0835	1.0	3.5	10.5	10.6	10.45	11.3	0.6	16.0
M10	RH-RB-UK-1040	1.0	4.0	12.8	12.8	12.65*	13.8	0.65	20.0

RH-KB-UK Reduce Head Knurled Body-UK 小沉头竖条纹(英标)

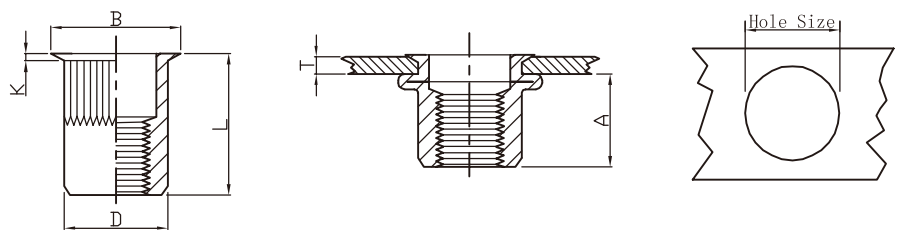

UNIT(单位): mm

螺纹 Thread	编号 P/N	T(GRIP RANGE)		A Rer	Hole Size $\begin{matrix} +0.1 \\ 0 \end{matrix}$	D $\pm 0.05 \begin{matrix} * \\ +0.07 \\ -0.1 \end{matrix}$	B	K	L
		Min	Max						
M3	RH-KB-UK-0315	0.5	1.5	5.5	4.8	4.65	5.4	0.4	9.0
M4	RH-KB-UK-0420	0.5	2.0	6.5	6.5	6.35	7.0	0.5	10.5
M5	RH-KB-UK-0525	0.5	2.5	7.5	7.25	7.15	7.85	0.5	12.0
M6	RH-KB-UK-0630	1.0	3.0	9.2	9.6	9.45	10.3	0.6	15.0
M8	RH-KB-UK-0835	1.0	3.5	10.5	10.6	10.45	11.3	0.6	16.0
M10	RH-KB-UK-1040	1.0	4.0	12.8	12.8	12.65*	13.8	0.65	20.0

RHH-IHB-UK Reduce Hex Head Inner Hex Body-UK 小沉头内外六角(英标)

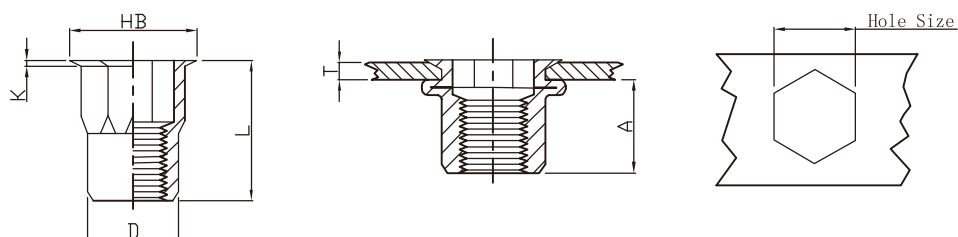

UNIT(单位): mm

螺纹 Thread	编号 P/N	T(GRIP RANGE)		A Rer	Hole Size $+0.1$ 0	D ± 0.05 (* ± 0.08)	HB	K	L
		Min	Max						
M4	RHH-IHB-UK-0420	0.5	2.0	6.5	6.4	6.25	7.25	0.5	10.5
M5	RHH-IHB-UK-0525	0.5	2.5	7.5	7.2	7.05	8.1	0.5	12.0*
M6	RHH-IHB-UK-0630	1.0	3.0	9.2	9.6	9.45	10.5*	0.6*	15.0*
M8	RHH-IHB-UK-0835	1.0	3.5	10.5	10.6	10.45	11.5*	0.65*	16.5*

FH-IHB-UK Flat Head Inner-Hex Body-UK 平头内外六角(英标)

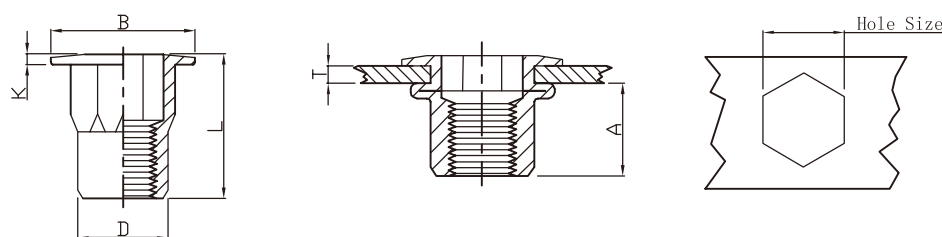

UNIT(单位): mm

螺纹 Thread	编号 P/N	T(GRIP RANGE)		A Rer	Hole Size $+0.1$ 0	D ± 0.05 (* ± 0.08)	B	K	L
		Min	Max						
M4	FH-IHB-UK-0420	0.5	2.0	6.5	6.4	6.25	9.5	0.6	10.5
M5	FH-IHB-UK-0525	0.5	2.5	7.5	7.2	7.05	10.0	0.8	12.0
M6	FH-IHB-UK-0630	1.0	3.0	9.2	9.6	9.4*	12.95*	1.0*	15.5*
M8	FH-IHB-UK-0835	1.0	3.5	10.5	10.6	10.45*	16.5*	1.15*	18.5*

产品展示

PRODUCT INTRODUCE

FH-KB-US Flat Head Knurled Body-AVK 平头(菊花)竖条纹(美标)

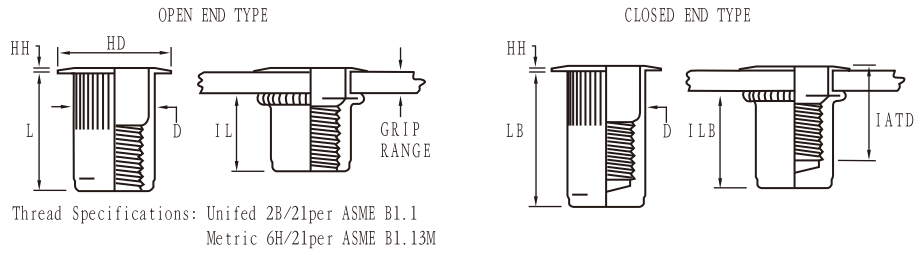

UNIT(单位):INCH

Thread Size	Thread Call Out	Grip Range	Grip Call Out	Hole Size + $\frac{.006}{.000}$	HD $\pm\frac{.010}{.205}$	HH $\pm\frac{.003}{.003}$	L $\pm\frac{.015}{.015}$	D MAX.	IL MAX.	LB $\pm\frac{.015}{.015}$	ILB MAX.	IATD* MAX.
6-32 UNC	632	.020-.080	80	17/64(.2656)	.390	.030	.420	.265	.305	.740	.640	.610
6-32UNC	632	.080-.130	130	17/64(.2656)	.390	.030	.470	.265	.305	.740	.580	.670
8-32UNC	832	.020-.080	80	17/64(.2656)	.390	.030	.420	.265	.305	.740	.640	.610
8-32UNC	832	.080-.130	130	17/64(.2656)	.390	.030	.470	.265	.305	.740	.580	.670
10-24UNC	1024	.020-.130	130	19/64(.2969)	.415	.030	.475	.296	.315	.990	.845	.730
10-24UNC	1024	.130-.225	225	19/64(.2969)	.415	.030	.585	.296	.315	.990	.735	.840
10-32 UNF	1032	.020-.130	130	19/64(.2969)	.415	.030	.475	.296	.315	.990	.845	.730
10-32 UNF	1032	.130-.225	225	19/64(.2969)	.415	.030	.585	.296	.315	.990	.735	.840
1/4-20 UNC	420	.027-.165	165	25/64(.3906)	.500	.030	.580	.390	.380	1.190	1.005	.895
1/4-20 UNC	420	.165-.260	260	25/64(.3906)	.500	.030	.680	.390	.380	1.190	.905	1.035
5/16-18 UNC	518	.027-.150	150	17/32(.5312)	.685*	.035	.690	.530	.470	1.390	1.175	.995
5/16-18 UNC	518	.150-.312	312	17/32(.5312)	.685*	.035	.805	.530	.425	1.390	1.025	1.120
3/8-16 UNC	616	.027-.150	150	17/32(.5312)	.685*	.035	.690	.530	.470	1.390	1.175	.995
3/8-16 UNC	616	.150-.312	312	17/32(.5312)	.685*	.035	.805	.530	.425	1.390	1.025	1.120
1/2-13 UNC	813	.063-.200	200	11/16(.6875)	.865*	.047	1.150	.685	.850	2.365	2.070	1.505
1/2-13 UNC	813	.200-.350	350	11/16(.6875)	.865*	.047	1.300	.685	.850	2.365	1.920	1.505
1/2-13 UNC	813	.365-.500	500	11/16(.6875)	.865*	.047	1.450	.685	.860	2.365	1.770	1.505

UNIT(单位): mm

Thread Size	Thread Call Out	Grip Range	Grip Call Out	Hole Size + $\frac{.015}{.000}$	HD $\pm\frac{.025}{.064}$	HH $\pm\frac{.008}{.008}$	L $\pm\frac{.038}{.038}$	D MAX.	IL MAX.	LB $\pm\frac{.038}{.038}$	ILB MAX.	IATD* MAX.
M4x0,7 ISO	470	0,50-2,00	2.0	6,75	9,91	0,76	10,67	6,73	7,75	18,80	16,26	15,49
M4x0,7 ISO	470	2,00-3,30	3.3	6,75	9,91	0,76	11,94	6,73	7,75	18,80	14,73	17,02
M5x0,8 ISO	580	0,50-3,30	3.3	7,60	10,54	0,76	12,07	7,52	8,00	25,15	21,46	18,54
M5x0,8 ISO	580	3,30-5,70	5.7	7,60	10,54	0,76	14,86	7,52	8,00	25,15	18,67	21,34
M6x1,0 ISO	610	0,70-4,20	4.2	10,00	12,70	0,76	14,73	9,91	9,65	30,23	25,53	22,73
M6x1,0 ISO	610	4,20-6,60	6.6	10,00	12,70	0,76	17,27	9,91	9,65	30,23	22,99	26,29
M8x1,25 ISO	8125	0,70-3,80	3.8	13,50	17,40*	0,89	17,53	13,46	11,94	35,31	29,85	25,27
M8x1,25 ISO	8125	3,80-7,90	7.9	13,50	17,40*	0,89	20,45	13,46	10,80	35,31	26,04	28,45
M10x1,5 ISO	1015	0,70-3,80	3.8	13,50	17,40*	0,89	17,53	13,46	11,94	35,31	29,85	25,27
M10x1,5 ISO	1015	3,80-7,90	7.9	13,50	17,40*	0,89	20,45	13,46	10,80	35,31	26,04	28,45
M12x1,75 ISO	12175	1,60-5,10	5.1	17,45	21,97*	1,19	29,21	17,4	21,59	60,07	52,58	38,23
M12x1,75 ISO	12175	5,10-8,90	8.9	17,45	21,97*	1,19	33,02	17,4	21,59	60,07	48,77	38,23
M12x1,75 ISO	12175	8,90-12,7	12.7	17,45	21,97*	1,19	36,83	17,4	21,84	60,07	44,96	38,23

SFH-KB-US Small Flat Head Knurled Body-AVK 平头(菊花)竖条纹(美标)

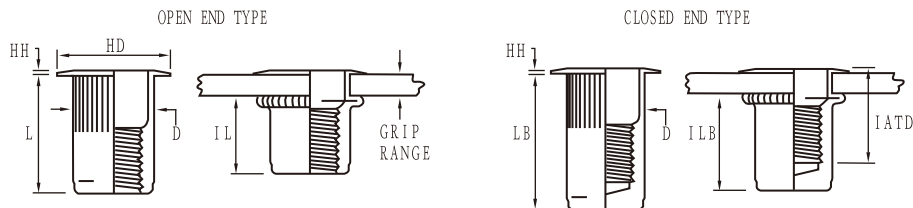

Thread Specifications: Unified 2B/21per ASME B1.1
Metric 6H/21per ASME B1.13M

UNIT(单位):INCH

Thread Size	Thread Call Out	Grip Range	Grip Call Out	Hole Size $+0.06$ -0.00	HD ± 0.10	HH ± 0.02	L ± 0.15	D MAX.	IL MAX.	LB ± 0.15	ILB MAX.	IATD* MAX.
6-32 UNC	632	.020-.080	80	17/64(.2656)	.310	.019	.420	.265	.305	.740	.640	.610
6-32 UNC	632	.080-.130	130	17/64(.2656)	.310	.019	.470	.265	.305	.740	.580	.670
8-32 UNC	832	.020-.080	80	17/64(.2656)	.310	.019	.420	.265	.305	.740	.640	.610
8-32 UNC	832	.080-.130	130	17/64(.2656)	.310	.019	.470	.265	.305	.740	.580	.670
10-24 UNC	1024	.020-.130	130	19/64(.2969)	.340	.019	.475	.296	.315	.990	.845	.730
10-24 UNC	1024	.130-.225	225	19/64(.2969)	.340	.019	.585	.296	.315	.990	.735	.840
10-32 UNF	1032	.020-.130	130	19/64(.2969)	.340	.019	.475	.296	.315	.990	.845	.730
10-32 UNF	1032	.130-.225	225	19/64(.2969)	.340	.019	.585	.296	.315	.990	.735	.840
1/4-20 UNC	420	.027-.165	165	25/64(.3906)	.455	.022	.580	.390	.380	1.190	1.005	.895
1/4-20 UNC	420	.165-.260	260	25/64(.3906)	.455	.022	.680	.390	.380	1.190	.905	1.035
5/16-18 UNC	518	.027-.150	150	17/32(.5312)	.595	.022	.690	.530	.470	1.390	1.175	.995
5/16-18 UNC	518	.150-.312	312	17/32(.5312)	.595	.022	.805	.530	.425	1.390	1.025	1.120
3/8-16 UNC	616	.027-.150	150	17/32(.5312)	.595	.022	.690	.530	.470	1.390	1.175	.995
3/8-16 UNC	616	.150-.312	312	17/32(.5312)	.595	.022	.805	.530	.425	1.390	1.025	1.120

UNIT(单位): mm

Thread Size	Thread Call Out	Grip Range	Grip Call Out	Hole Size $+0.15$ -0.00	HD ± 0.25	HH ± 0.05	L ± 0.38	D MAX	IL MAX	LB ± 0.38	ILB MAX	IATD* MAX
M4x0,7 ISO	470	0,50-2,00	2.0	6,75	7,87	0,48	10,67	6,73	7,75	18,80	16,26	15,49
M4x0,7 ISO	470	2,00-3,30	3.3	6,75	7,87	0,48	11,94	6,73	7,75	18,80	14,73	17,02
M5x0,8 ISO	580	0,50-3,30	3.3	7,60	8,64	0,48	12,07	7,52	8,00	25,15	21,46	18,54
M5x0,8 ISO	580	3,30-5,70	5.7	7,60	8,64	0,48	14,86	7,52	8,00	25,15	18,67	21,34
M6x1,0 ISO	610	0,70-4,20	4.2	10,00	11,56	0,55	14,73	9,91	9,65	30,23	25,53	22,73
M6x1,0 ISO	610	4,20-6,60	6.6	10,00	11,56	0,55	17,27	9,91	9,65	30,23	22,99	26,29
M8x1,25 ISO	8125	0,70-3,80	3.8	13,50	15,11	0,55	17,53	13,46	11,94	35,31	29,85	25,27
M8x1,25 ISO	8125	3,80-7,90	7.9	13,50	15,11	0,55	20,45	13,46	10,80	35,31	26,04	28,45
M10x1,5 ISO	1015	0,70-3,80	3.8	13,50	15,11	0,55	17,53	13,46	11,94	35,31	29,85	25,27
M10x1,5 ISO	1015	3,80-7,90	7.9	13,50	15,11	0,55	20,45	13,46	10,80	35,31	26,04	28,45

产品展示

PRODUCT INTRODUCE

FH-RB/SS Flat Head Round Body Plain 不锈钢平头菊花

Stainless Steel

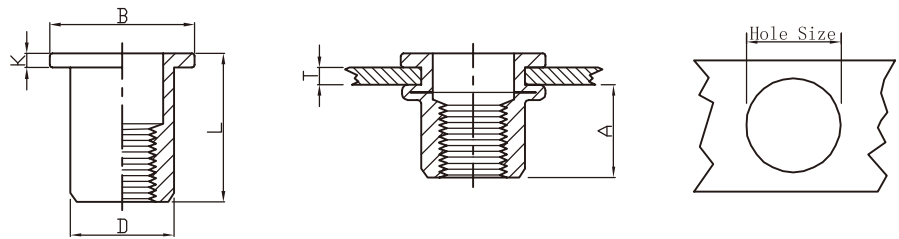

UNIT(单位): mm

螺纹 Thread	编号 P/N	T(GRIP RANGE) Min Max	A Ref	Hole Size $+0.1$ 0	D $+0.07$ -0.1	B	K	L
M4	FH-RB/SS-0420	0.5-2.0	6.0	6.0	5.9	8.5	0.8	10.5
M5	FH-RB/SS-0525	0.5-2.5	7.5	7.0	6.9	10.0	1.0	13.0
M6	FH-RB/SS-0630	0.5-3.0	9.2	9.0	8.9	12.3	1.3	15.5
M8	FH-RB/SS-0835	1.0-3.5	11.5	11.0	10.9	15.0	1.5	18.5
M10	FH-RB/SS-1040	1.0-4.0	12.5	13.0	12.9	17.0	1.6	21.0

FH-RBC/SS Flat Head Round Body Plain Close End 不锈钢平头菊花(盲孔)

Stainless Steel

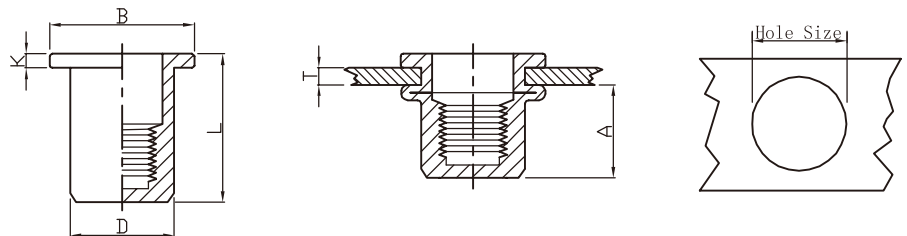

UNIT(单位): mm

螺纹 Thread	编号 P/N	T(GRIP RANGE) Min Max	A Ref	Hole Size $+0.1$ 0	D $+0.07$ -0.1	B	K	L
M4	FH-RBC/SS-0420	0.5-2.0	11.3	6.0	5.9	9.0	0.8	16.0
M5	FH-RBC/SS-0525	0.5-2.5	13.8	7.0	6.9	10.0	1.0	19.0
M6	FH-RBC/SS-0630	0.5-3.0	15.0	9.0	8.9	12.3	1.3	21.0
M8	FH-RBC/SS-0835	1.0-3.5	18.2	11.0	10.9	15.5	1.5	25.0
M10	FH-RBC/SS-1040	1.0-4.0	19.4	13.0	12.9	17.0	1.6	27.0

FH-KB/SS Flat Head Knurled Body 不锈钢平头菊花竖条纹

Stainless Steel

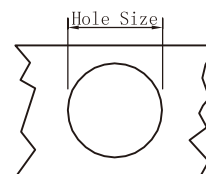
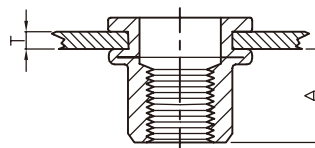
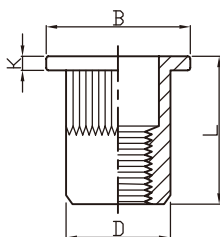

UNIT(单位): mm

螺纹 Thread	编号 P/N	T(GRIP RANGE)		A Ref	Hole Size $+0.1$ 0	D $+0.07$ -0.1	B $+0.25$ -0.1	K	L
		Min	Max						
M4	FH-KB/SS-0420	0.5	2.0	6.5	6.0	5.9	9.0	0.8	10.5
M5	FH-KB/SS-0525	0.5	2.5	8.0	7.0	6.9	10.0	1.0	13.0
M6	FH-KB/SS-0630	0.5	3.0	9.2	9.0	8.9	12.3	1.3	15.5
M8	FH-KB/SS-0835	1.0	3.5	11.5	11.0	10.9	14.5	1.5	18.5
M10	FH-KB/SS-1040	1.0	4.0	13.5	13.0	12.9	17.0	1.6	21.0

FH-KBC/SS Flat Head Knurled Body Close End 不锈钢平头菊花竖条纹(盲孔)

Stainless Steel

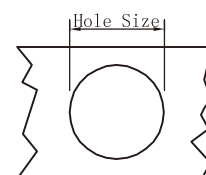
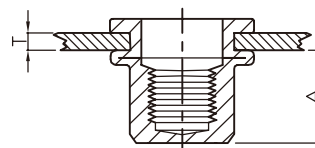
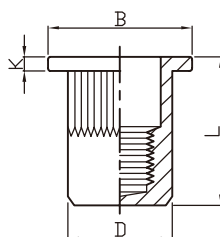

UNIT(单位): mm

螺纹 Thread	编号 P/N	T(GRIP RANGE)		A Ref	Hole Size $+0.1$ 0	D $+0.07$ -0.1	B	K	L
		Min	Max						
M4	FH-KBC/SS-0420	0.5	2.0	11.8	6.0	5.9	9.0	0.8	16.0
M5	FH-KBC/SS-0525	0.5	2.5	12.0	7.0	6.9	10.0	1.0	17.0
M6	FH-KBC/SS-0630	0.5	3.0	12.7	9.0	8.9	12.3	1.3	19.2
M8	FH-KBC/SS-0835	1.0	3.5	14.2	11.0	10.9	15.0	1.5	21.5
M10	FH-KBC/SS-1040	1.0	4.0	18.0	13.0	12.9	17.0	1.6	27.0

产品展示

PRODUCT INTRODUCE

RH-RB/SS Reduce Head Round Body Plain 不锈钢小沉头圆柱

Stainless Steel

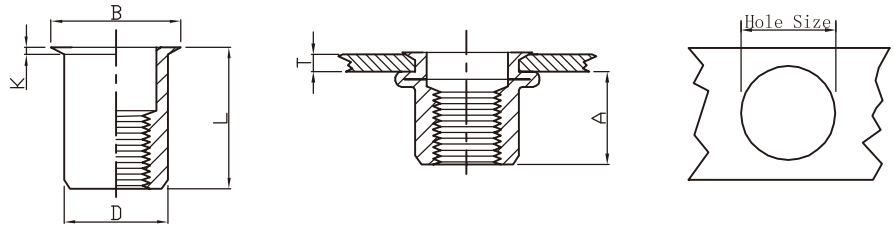

UNIT(单位): mm

螺纹 Thread	编号 P/N	T(GRIP RANGE)		A Ref	Hole Size $+0.1$ 0	D $+0.07$ -0.1	B	K	L
		Min	Max						
M4	RH-RB/SS-0420	0.5	2.0	6.5	6.0	5.9	7.0	0.5	10.5
M5	RH-RB/SS-0520	0.5	2.0	7.0	7.0	6.9	8.0	0.5	11.5
M6	RH-RB/SS-0625	0.5	2.5	8.5	9.0	8.9	10.0	0.6	14.0
M8	RH-RB/SS-0830	0.5	3.0	10.5	11.0	10.9	12.0	0.65	16.5
M10	RH-RB/SS-1035	1.0	3.5	11.5	13.0	12.9	14.0	0.7	17.7

RH-RBC/SS Reduce Head Round Body Plain Close End 不锈钢小沉头圆柱(盲孔)

Stainless Steel

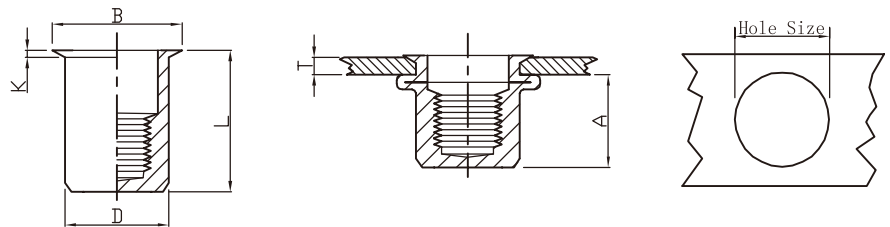

UNIT(单位): mm

螺纹 Thread	编号 P/N	T(GRIP RANGE)		A Ref	Hole Size $+0.1$ 0	D $+0.07$ -0.1	B	K	L
		Min	Max						
M4	RH-RBC/SS-0420	0.5	2.0	11.0	6.0	5.9	7.0	0.5	15.0
M5	RH-RBC/SS-0520	0.5	2.0	12.5	7.0	6.9	8.0	0.5	16.5
M6	RH-RBC/SS-0625	0.5	2.5	15.5	9.0	8.9	10.0	0.6	20.5
M8	RH-RBC/SS-0830	0.5	3.0	17.6	11.0	10.9	12.0	0.65	23.0
M10	RH-RBC/SS-1035	1.0	3.5	18.3	13.0	12.9	14.0	0.7	24.5

RH-KB/SS Reduce Head Knurled Body 不锈钢小沉头竖条纹

Stainless Steel

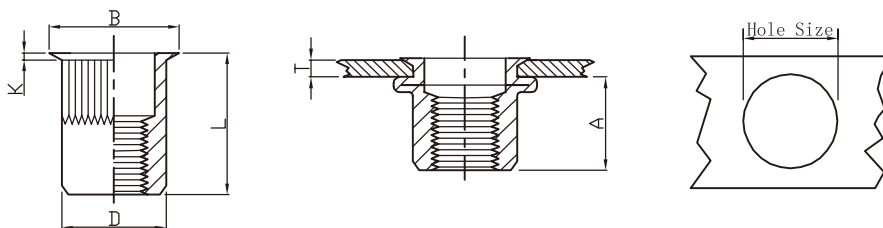

UNIT(单位): mm

螺纹 Thread	编号 P/N	T(GRIP RANGE)		A Ref	Hole Size $\begin{smallmatrix} +0.1 \\ 0 \end{smallmatrix}$	D $\begin{smallmatrix} +0.07 \\ -0.1 \end{smallmatrix}$	B	K	L
		Min	Max						
M4	RH-KB/SS-0420	0.5	2.0	6.5	6.0	5.9	7.0	0.5	10.5
M5	RH-KB/SS-0520	0.5	2.0	7.2	7.0	6.9	8.0	0.5	11.5
M6	RH-KB/SS-0625	0.5	2.5	8.7	9.0	8.9	10.0	0.6	14.0
M8	RH-KB/SS-0830	0.5	3.0	10.5	11.0	10.9	12.0	0.65	16.5
M10	RH-KB/SS-1035	1.0	3.5	10.7	13.0	12.9	14.0	0.7	17.7

RH-KBC/SS Reduce Head Knurled Body Close End 不锈钢小沉头竖条纹(盲孔)

Stainless Steel

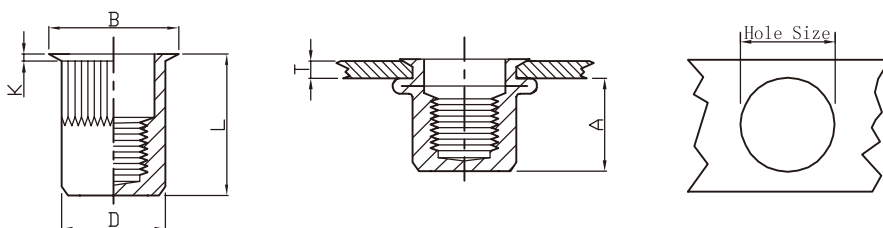

UNIT(单位): mm

螺纹 Thread	编号 P/N	T(GRIP RANGE)		A Ref	Hole Size $\begin{smallmatrix} +0.1 \\ 0 \end{smallmatrix}$	D $\begin{smallmatrix} +0.07 \\ -0.1 \end{smallmatrix}$	B	K	L
		Min	Max						
M4	RH-KBC/SS-0420	0.5	2.0	11.2	6.0	5.9	7.0	0.5	15.0
M5	RH-KBC/SS-0520	0.5	2.0	11.5	7.0	6.9	8.0	0.5	16.5
M6	RH-KBC/SS-0625	0.5	2.5	15.0	9.0	8.9	10.0	0.6	20.5
M8	RH-KBC/SS-0830	0.5	3.0	17.5	11.0	10.9	12.0	0.65	23.0
M10	RH-KBC/SS-1035	1.0	3.5	18.0	13.0	12.9	14.0	0.7	24.5

产品展示

PRODUCT INTRODUCE

CH-RB/SS Countersunk Head Round Body Plain 不锈钢大沉头圆柱

Stainless Steel

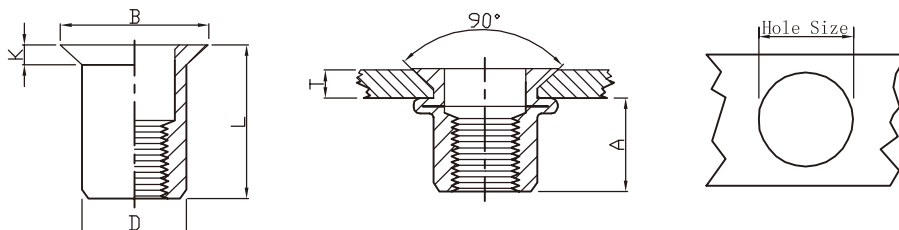

UNIT(单位): mm

螺纹 Thread	编号 P/N	T(GRIP RANGE)		A Ref	Hole Size $\begin{matrix} +0.1 \\ 0 \end{matrix}$	D $\begin{matrix} +0.07 \\ -0.1 \end{matrix}$	B	K	L
		Min	Max						
M4	CH-RB/SS-0430	1.5	3.0	7.5	6.0	5.9	9.0	1.5	12.0
M5	CH-RB/SS-0535	1.5	3.5	7.8	7.0	6.9	10.0	1.5	13.0
M6	CH-RB/SS-0640	1.5	4.0	9.0	9.0	8.9	12.0	1.5	15.5
M8	CH-RB/SS-0845	2.0	4.5	12.0	11.0	10.9	14.0	1.5	18.5
M10	CH-RB/SS-1050	2.0	5.0	13.0	13.0	12.9	16.0	1.5	21.0

CH-KB/SS Countersunk Head Knurled Body 不锈钢大沉头菊花竖条纹

Stainless Steel

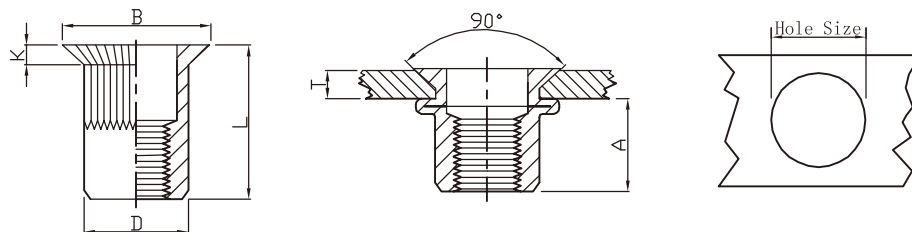

UNIT(单位): mm

螺纹 Thread	编号 P/N	T(GRIP RANGE)		A Ref	Hole Size $\begin{matrix} +0.1 \\ 0 \end{matrix}$	D $\begin{matrix} +0.07 \\ -0.1 \end{matrix}$	B	K	L
		Min	Max						
M4	CH-KB/SS-0430	1.5	3.0	7.5	6.0	5.9	9.0	1.5	12.0
M5	CH-KB/SS-0535	1.5	3.5	7.8	7.0	6.9	10.0	1.5	13.0
M6	CH-KB/SS-0640	1.5	4.0	9.0	9.0	8.9	12.0	1.5	15.5
M8	CH-KB/SS-0845	2.0	4.5	12.0	11.0	10.9	14.0	1.5	18.5
M10	CH-KB/SS-1050	2.0	5.0	13.0	13.0	12.9	16.0	1.5	21.0

RHH-IHB/SS Reduce Hex Head Inner-Hex Body 不锈钢小沉头内外六角

Stainless Steel

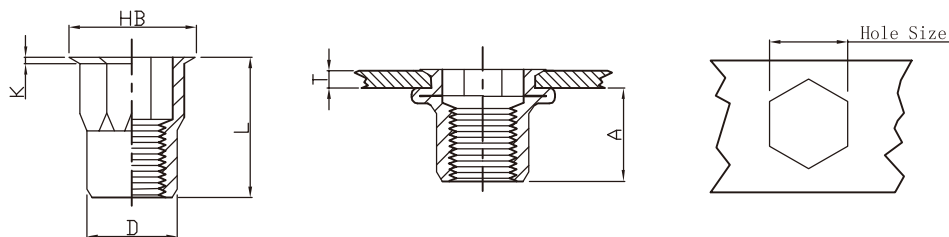

UNIT(单位): mm

螺纹 Thread	编号 P/N	T(GRIP RANGE)		A Ref	Hole Size $+0.1$ 0	D $+0.07$ -0.1	HB	K	L
		Min	Max						
M4	RHH-IHB/SS-0420	0.5	2.0	8.0	6.0	5.9	7.0	0.5	12.0
M5	RHH-IHB/SS-0525	0.5	2.5	8.2	7.0	6.9	8.0	0.5	13.0
M6	RHH-IHB/SS-0630	0.5	3.0	10.7	9.0	8.9	10.0	0.6	16.0
M8	RHH-IHB/SS-0835	1.0	3.5	11.2	11.0	10.9	12.0	0.65	17.5
M10	RHH-IHB/SS-1040	1.0	4.0	13.5	13.0	12.9	14.5*	0.75	21.0

RHH-IHBC/SS Reduce Hex Head Inner-Hex Body Close End 不锈钢小沉头内外六角(盲孔)

Stainless Steel

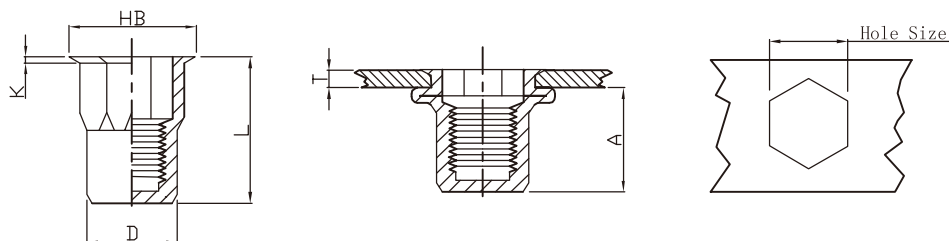

UNIT(单位): mm

螺纹 Thread	编号 P/N	T(GRIP RANGE)		A Ref	Hole Size $+0.1$ 0	D $+0.07$ -0.1	HB	K	L
		Min	Max						
M4	RHH-IHBC/SS-0420	0.5	2.0	11.5	6.0	5.9	7.0	0.5	15.5
M5	RHH-IHBC/SS-0525	0.5	2.5	13.5	7.0	6.9	8.0	0.5	18.0
M6	RHH-IHBC/SS-0630	0.5	3.5	15.8	9.0	8.9	10.0	0.6	21.5
M8	RHH-IHBC/SS-0835	1.0	3.5	18.2	11.0	10.9	12.0	0.65	24.0
M10	RHH-IHBC/SS-1040	1.0	4.0	23.2	13.0	12.9	14.5	0.75	30.5

产品展示

PRODUCT INTRODUCE

FH-IHB/SS Flat Head Inner-Hex Body 不锈钢平头内外六角

Stainless Steel

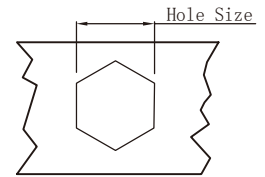
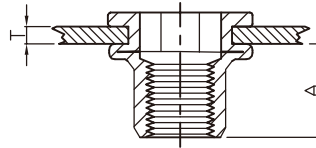
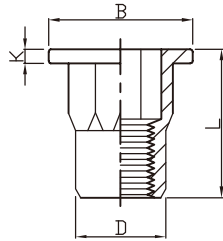

UNIT(单位): mm

螺纹 Thread	编号 P/N	T(GRIP RANGE) Min Max	A Ref	Hole Size $+0.1$ 0	D $+0.07$ -0.1	B	K	L
M4	FH-IHB/SS-0420	0.5-2.0	7.2	6.0	5.9	9.0	0.8	11.0
M5	FH-IHB/SS-0525	0.5-2.5	7.5	7.0	6.9	10.0	1.0	12.0
M6	FH-IHB/SS-0630	0.5-3.0	9.2	9.0	8.9	12.7	1.3	15.5
M8	FH-IHB/SS-0835	1.0-3.5	11.0	11.0	10.9	16.0	1.5	18.0
M10	FH-IHB/SS-1040	1.0-4.0	13.2	13.0	12.9	18.0	1.7	21.0

FH-IHBC/SS Flat Head Inner-Hex Body Close End 不锈钢平头内外六角(盲孔)

Stainless Steel

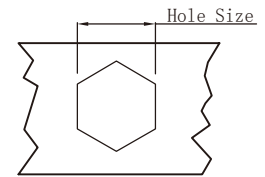
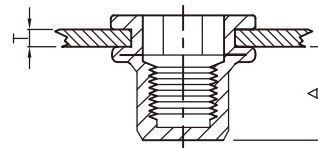
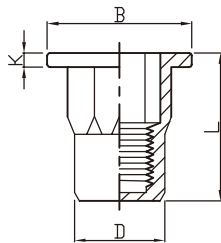

UNIT(单位): mm

螺纹 Thread	编号 P/N	T(GRIP RANGE) Min Max	A Ref	Hole Size $+0.1$ 0	D $+0.07$ -0.1	B	K	L
M4	FH-IHBC/SS-0420	0.5-2.0	11.5	6.0	5.9	9.0	1.0*	16.0
M5	FH-IHBC/SS-0525	0.5-2.5	13.5	7.0	6.9	10.0	1.0	18.5
M6	FH-IHBC/SS-0630	0.5-3.0	17.0	9.0	8.9	12.7	1.5	23.0
M8	FH-IHBC/SS-0835	1.0-3.5	18.2	11.0	10.9	16.0	1.5	25.0*
M10	FH-IHBC/SS-1040	1.0-4.0	25.0	13.0	12.9	19.0	1.7	33.0*

FH-RB/AL Flat Head Round Body Plain 铝平头菊花

Aluminium

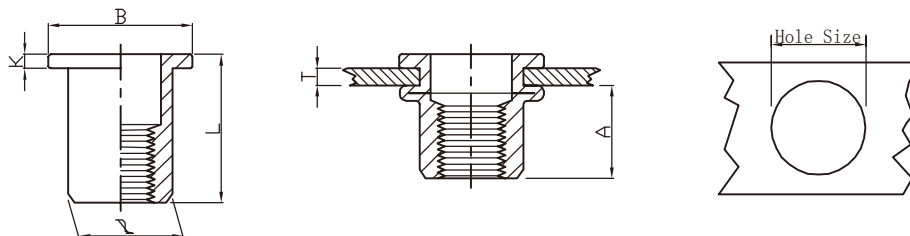

UNIT(单位): mm

螺纹 Thread	编号 P/N	T(GRIP RANGE)		A Ref	Hole Size $+0.1$ 0	D $+0.07$ -0.1	B	K	L
		Min	Max						
M4	FH-RB/AL-0420	0.5	2.0	6.0	6.0	5.9	8.8*	0.8*	10.5*
M5	FH-RB/AL-0525	0.5	2.5	7.5	7.0	6.9	10.0	1.0	13.0
M6	FH-RB/AL-0625	0.5	2.5	9.2	9.0	8.9	12.3	1.5	15.0
M8	FH-RB/AL-0830	1.0	3.0	10.2	11.0	10.9	14.3	1.5	16.5
M10	FH-RB/AL-1040	1.0	4.0	11.5	13.0	12.9	16.3	1.6	19.0

RH-RB/AL Reduce Head Round Body Plain 铝小沉头圆柱

Aluminium

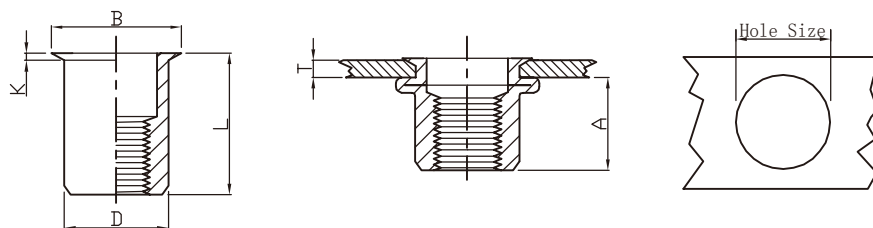

UNIT(单位): mm

螺纹 Thread	编号 P/N	T(GRIP RANGE)		A Ref	Hole Size $+0.1$ 0	D $+0.07$ -0.1	B	K	L
		Min	Max						
M4	RH-RB/AL-0420	0.5	2.0	6.0	6.0	5.9	7.0	0.5	10.5
M5	RH-RB/AL-0520	0.5	2.0	7.5	7.0	6.9	8.0	0.5	11.5
M6	RH-RB/AL-0625	0.5	2.5	9.2	9.0	8.9	10.0	0.6*	14.0*
M8	RH-RB/AL-0825	0.5	2.5	10.2	11.0	10.9	12.0	0.65*	15.5*
M10	RH-RB/AL-1030	1.0	3.0	11.5	13.0	12.9	14.1	0.7*	17.7*

产品展示

PRODUCT INTRODUCE

FH-KB/AL Flat Head Knurled Body 铝平头菊花竖条纹

Aluminium

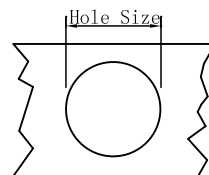
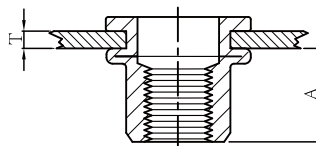
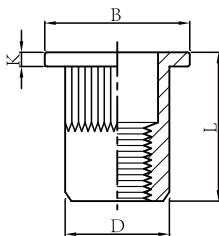

UNIT(单位): mm

螺纹 Thread	编号 P/N	T(GRIP RANGE)		A Ref	Hole Size $\begin{smallmatrix} +0.1 \\ 0 \end{smallmatrix}$	D	B	K	L
		Min	Max						
M4	FH-KB/AL-0420	0.5	2.0	6.0	6.0	5.9	8.8*	0.8*	10.5*
M5	FH-KB/AL-0525	0.5	2.5	7.5	7.0	6.9	10.0	1.0	13.0
M6	FH-KB/AL-0625	0.5	2.5	9.2	9.0	8.9	12.3	1.5	15.0
M8	FH-KB/AL-0830	1.0	3.0	10.2	11.0	10.9	14.3	1.5	16.5
M10	FH-KB/AL-1040	1.0	4.0	11.5	13.0	12.9	16.3	1.6	19.0

RH-KB/AL Reduce Head Knurled Body 铝小沉头竖条纹

Aluminium

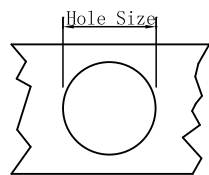
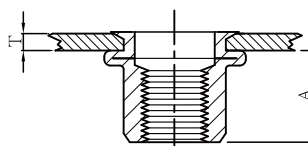
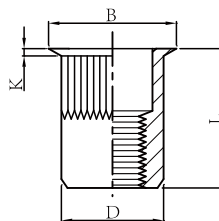

UNIT(单位): mm

螺纹 Thread	编号 P/N	T(GRIP RANGE)		A Ref	Hole Size $\begin{smallmatrix} +0.1 \\ 0 \end{smallmatrix}$	D $\begin{smallmatrix} +0.07 \\ -0.1 \end{smallmatrix}$	B	K	L
		Min	Max						
M4	RH-KB/AL-0420	0.5	2.0	6.0	6.0	5.9	7.0	0.5	10.5
M5	RH-KB/AL-0520	0.5	2.0	7.5	7.0	6.9	8.0	0.5	11.5
M6	RH-KB/AL-0625	0.5	2.5	9.2	9.0	8.9	10.0	0.6*	14.0*
M8	RH-KB/AL-0825	0.5	2.5	10.2	11.0	10.9	12.0	0.65*	15.5*
M10	RH-KB/AL-1030	1.0	3.0	11.5	13.0	12.9	14.1	0.7*	17.7*

FH-SQB Flat Head Square Body 平头方型铆螺母

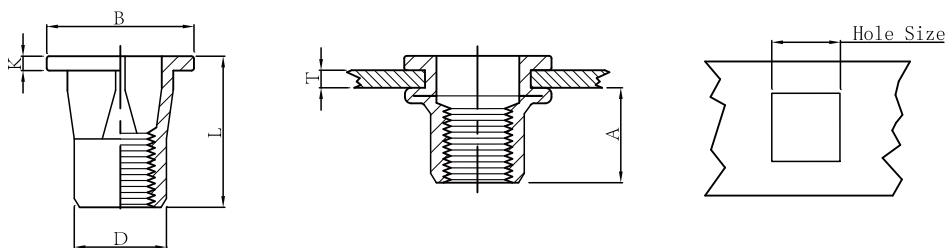

UNIT(单位): mm

螺纹 Thread	编号 P/N	T(GRIP RANGE)		A Ref	Hole Size $+0.1$ 0	D $+0.07$ -0.1	B	K	L
		Min	Max						
M5	FH-SQB-0515	0.5	1.5	8	7.0	6.9	10.5	0.6	11.2
	FH-SQB-0530	1.5	3.0						
M6	FH-SQB-0625	0.5	2.5	8.5	9.0	8.9	14.0*	0.8*	14.3
	FH-SQB-0640	2.5	4.0	9.5				0.8*	17.2*
M8	FH-SQB-0830	1.0	3.0	11.5	11.0	10.9	17.5*	1.3*	18.6*

FH-SLB Flat Head Slotted Body 膨胀铆螺母

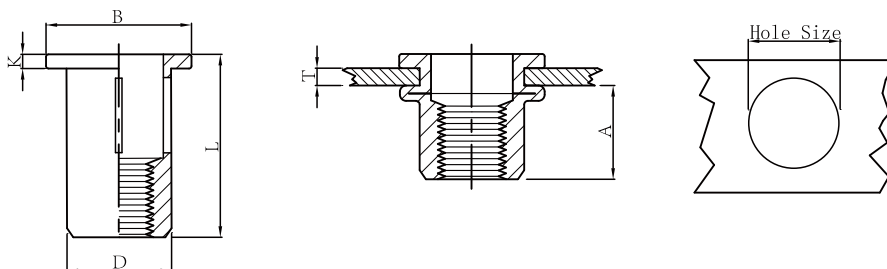

UNIT(单位): mm

螺纹 Thread	编号 P/N	T(GRIP RANGE)		A Ref	Hole Size $+0.1$ 0	D $+0.07$ -0.1	B	K	L
		Min	Max						
M5	FH-SLB-0545	0.5	4.5	9.6	7.5	7.4	12.7	1.0	22.0
M6	FH-SLB-0670	0.5	7.0	12.5	8.8	8.7	16.0	1.5	27.0
M8	FH-SLB-0870	1.0	7.0	14.3	11.1	11.0	19.0	1.6	30.5

产品展示▶▶▶ PRODUCT INTRODUCE

Other 其它



※我们除了样本中的标准铆螺母以外,还生产其他很多非标类铆螺母以及其他非标汽车紧固件.
We offer lots of non-standard rivet nuts that you can not find in the catalogue also lots auto parts.

Other 其它



六角法兰面焊接螺母Hexagon Weld Nuts with Flange



六角焊接螺母Hexagon Weld Nuts



四方焊接螺母Square Weld Nuts



圆形焊接螺母Round Weld Nuts



四方焊接螺母Square Weld Nuts



圆形焊接螺母Round Weld Nuts



圆形焊接螺母Round Weld Nuts



T型焊接螺母T Weld Nuts

压铆螺母技术参数

SELF CLINCH NUT DATA SHEET

Other 其它

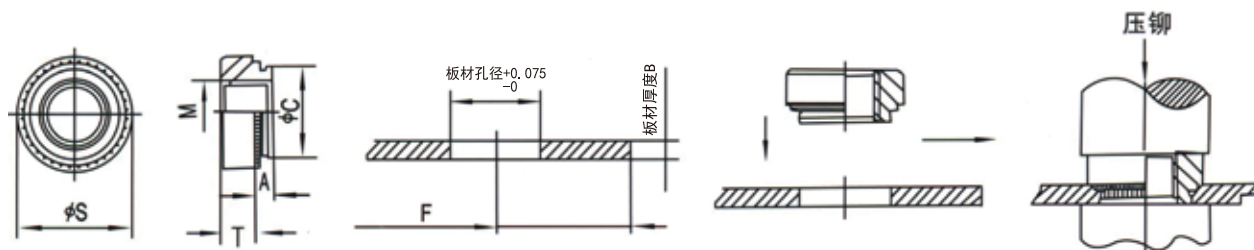

SELF CLINCH NUT DATA SHEET

INCH	METRIC	(Z)	A(MAX)	T	SHEE	HOBE SIZE(D)	C(MAX)	S \pm 0.15	F
	M2.5 \times 0.4	0 Z	0.75		0.8~1				
		1 Z	0.95	1.5	1	4.25	4.22	6.3	4.8
		2 Z	1.35			1.4~2.0			
.112-40 #4-40	M3 \times 0.5	0 Z	0.75		0.8~1				
		1 Z	0.95	1.5	1~1.2	4.25	4.22	6.3	4.8
		2 Z	1.35		1.4~2.0				
.138-32 #6-32	M3.5 \times 0.6	0 Z	0.75		0.8~1				
		1 Z	0.95	1.5	1~1.2	4.75	4.7	7.1	5.6
		2 Z	1.35		1.4~2.0				
.164-32 #8-32	M4 \times 0.7	0 Z	0.75		0.8~1				
		1 Z	0.95		1~1.2				
		2 Z	1.35	2.0	1.4~2.0	5.4	5.38	7.9	6.9
.190-32 #10-32	M5 \times 0.8	0 Z	0.75		0.8~1				
		1 Z	0.95		1~1.2				
		2 Z	1.35	2.0	1.4~2.0	6.4	6.38	8.7	7.1
.250-20 #1/4-20	M6 \times 1	0 Z	1.15		1.2~1.4				
		1 Z	1.35	4.0	1.4~2.2	8.75	8.72	11.05	8.6
		2 Z	2.20		2.3~3.0				
.312-18 5/16-18	M8 \times 1.25	0 Z	1.15		1.2~1.4				
		1 Z	1.35		1.4				
		2 Z	2.20	5.5	2.3	10.5	10.44	12.65	9.7
M10 \times 1.5	M10 \times 1.5	0 Z	1.15		1.2~1.4				
		1 Z	1.35	7.5	2.3	14	13.95	17.35	13.5
		2 Z	3.05		3.2				

Other 其它



※气动铆枪 pneumatic tool



※手动铆枪 manual tool



※压铆螺母 self clinch nuts

展望未来 ▶▶▶

LOOKING FORWARD TO THE FUTURE

融入世界，合作共赢。

锐拓追求成熟化、国际化发展的脚步从未停止。

在新的全球竞争环境里，

锐拓人始终坚信，民族的，就是世界的。

Integrating into the world and carrying out win-win cooperation with other countries and enterprises.

The pursuing pace of Rivet to maturity and international development is never stopped.

In the new global competitive environment, Rivet people always believe that the things belonging to the nation is also belonging to the world.





上海锐拓五金制品有限公司

销售部

电话: +86-21-57276222 37286068 37286069

传真: +86-21-37286067

邮箱: sales@ret-global.com

地址: 上海市金山工业区天工路88号201506

出口部

电话: +86-21-37286065 37286522

传真: +86-21-37286066

邮箱: sales@ret-global.com chinariwet@gmail.com

www.ret-global.com

SHANGHAI RIVET MANUFACTURE CO., LTD.

Export Department

Tel: +86-21-37286065 37286522

Fax: +86-21-37286066

E-mail: sales@ret-global.com chinariwet@gmail.com

Address: #88 tiangong road jinshan industrial zone shanghai China 201506

Domestic Department

Tel: +86-21-57276222 37286068 37286069

Fax: +86-21-37286067

E-mail: sales@ret-global.com

